

IN-GROUND INSTALLATION GUIDE



Congratulations on your new in-ground trampoline!

Here's a quick step by step guide to help get you and your loved ones bouncing on your new trampoline!

Experience, soil, labouring are all factors in getting the job done. The usual process takes 3 days, however work to your own capabilities and if you are ever stuck don't hesitate to call us for clarification: **03 9571 5711**

Please note: Installation can vary from job to job.

DAY ONE:

1. Bolt your frame together (as you can see in the picture below – in the top left corner)
2. Lay the frame in the location you wish to set your trampoline and with a shovel mark out where the legs and frame will go. As you can see in the image below, there are 6 legs to dig (8 if you have an Olympic Elite model) the centre legs are double legs so the holes will have to be dug wider to accommodate.
3. The legs supplied are 600mm and the holes will need to be dug 750-800mm deep



DAY ONE:

CONTINUED

4. Once dug out footings for legs and frame, insert legs into the frame. Set the legs into the ground then use a spirit level to ensure your frame is level. Once level and happy with frame position, fill leg footings with concrete mix.

Nice work - Day 1 is complete!

Allow concrete to set before commencing with day 2.



DAY TWO:

5. Day 2 is a big day, it's excavation day! Using your machinery commence digging out your pit.



Tips: start from one end and work your way back. Pit recommended depth is 1200mm and should slope towards your pump (if you are installing one) or drainage pipe if you are choosing natural drainage. Please refer to *IN GROUND TRAMPOLINE INSTALLATION PLAN AND SECTION* drawings (specifically Pit detail section) for more accurate details

Pit has been excavated to correct depth and specs.

Note: *Sloped walls are shaped after excavation. This will help the walls stay strong and retain from collapsing.*

DAY THREE:

6. Now that your pit is excavated and shaped, lay down chicken wire and apply approx. 50 mm of concrete to all side of the pit.



Note – this is not a compulsory step, however has many benefits for future maintenance and gives a cleaner more professional look once done. Highly recommended.

Tips: When trailing the pit, it's easier to have someone help from above.



Here's what it should look like once finished.

Note: this pit does not have a pump, as it is located in QLD, the soil is great for natural drainage hence why the bottom of the pit is not concreted. Your pit may look different if you have dug a whole to fit a pump. We advise you concrete the bottom to help the water travel to the pump and not build up.

DAY THREE:

CONTINUED

7. Now comes the fun bit, Set your trampoline mat up, lay your rubber surrounding on and screw directly in to the frame. We normally lay the lengths first then the short ends over the top. 3 screws in every corner then space your screws and washers every 400mm.



Congratulations and well done, you are done! Nothing more to do than enjoy the fruits of your hard labour!

Jump safe, have fun, and enjoy the memories for years to come!

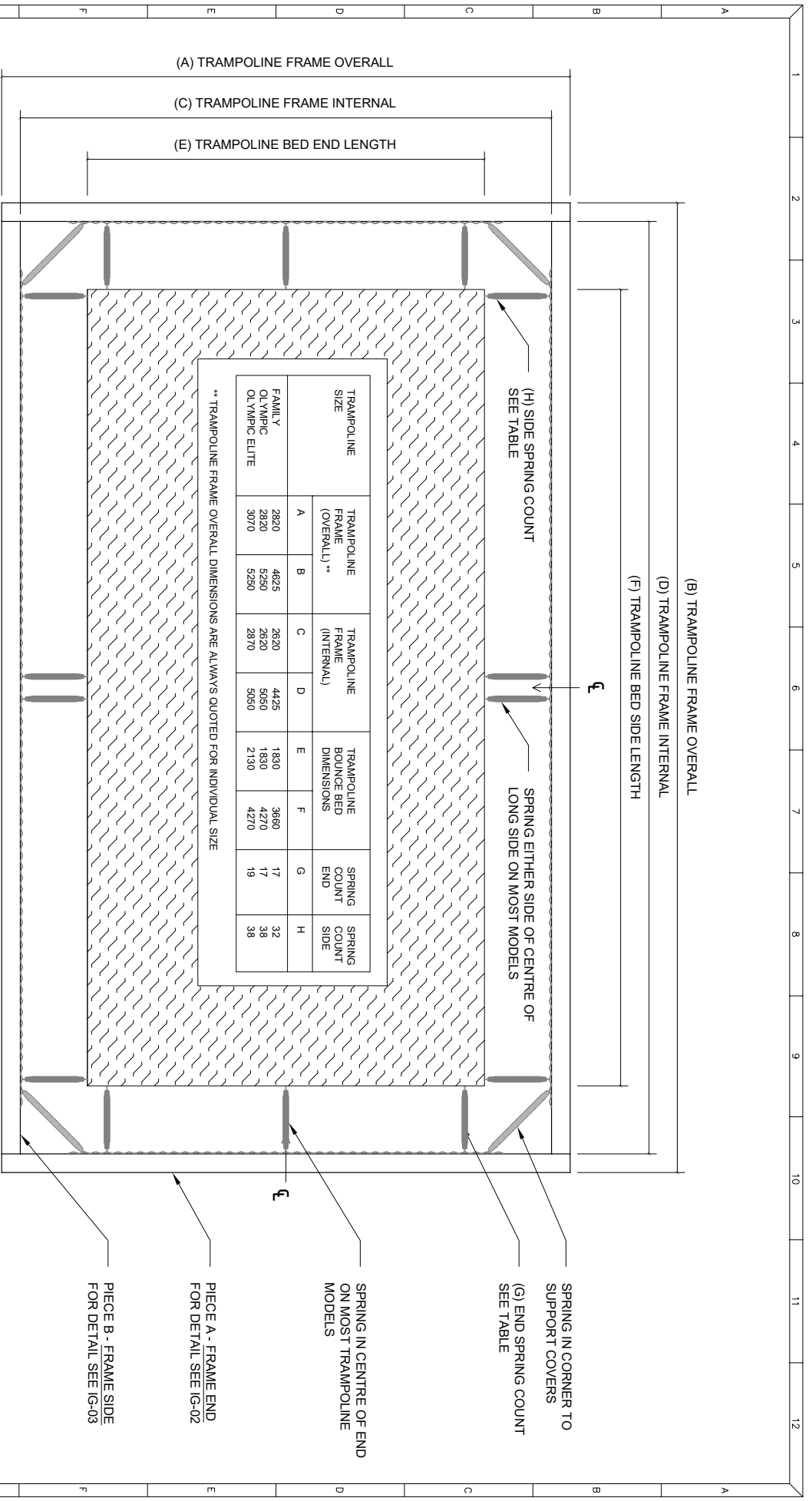

**** TRAMPOLINE FRAME OVERALL DIMENSIONS ARE ALWAYS QUOTED FOR INDIVIDUAL SIZE**

TRAMPOLINE SIZE	TRAMPOLINE FRAME (OVERALL) **		TRAMPOLINE FRAME (INTERNAL)		TRAMPOLINE BOUNCE BED DIMENSIONS		SPRING COUNT END	SPRING COUNT SIDE
	A	B	C	D	E	F	G	H
FAMILY OLYMPIC	2820	4825	2820	4425	1830	3660	17	32
OLYMPIC ELITE	2820	5250	2820	5050	1830	4270	17	38
	3070	5250	2870	5050	2130	4270	19	38

IN GROUND TRAMPOLINE - PLAN VIEW
SCALE 1:20 @A3

REV	DATE	ISSUE FOR REVIEW	DESCRIPTION	DESIGNED BY	CHECKED BY	DATE APPROVED	ISSUE FOR CONSTRUCTION	LOCATION	TITLE	SCALE	PAPER	REV
0	19/03/19	WC	TABLE DETAILS	AR	WC		NOTE:	N/A	IN GROUND TRAMPOLINE SIZE RANGE - PLAN VIEW	1:20	A3	
1	23/03/17	WC	ARRANGEMENT	WC	WC		ISSUE FOR CONSTRUCTION					
2	20/03/17	WC	WIGGLE BAR DETAIL	WC	WC							
3	17/03/17	WC	ISSUE FOR REVIEW	WC	WC							
4		WC	ISSUE FOR REVIEW	WC	WC							
5		WC	ISSUE FOR REVIEW	WC	WC							
6		WC	ISSUE FOR REVIEW	WC	WC							
7		WC	ISSUE FOR REVIEW	WC	WC							
8		WC	ISSUE FOR REVIEW	WC	WC							
9		WC	ISSUE FOR REVIEW	WC	WC							
10		WC	ISSUE FOR REVIEW	WC	WC							
11		WC	ISSUE FOR REVIEW	WC	WC							
12		WC	ISSUE FOR REVIEW	WC	WC							

+ MR TRAMPOLINE
Premium Bounce Ultimate Flight

LOCATION: N/A
TITLE: IN GROUND TRAMPOLINE SIZE RANGE - PLAN VIEW
SCALE: 1:20
DRAWING NUMBER: IG-01
PAPER: A3
REV: 0

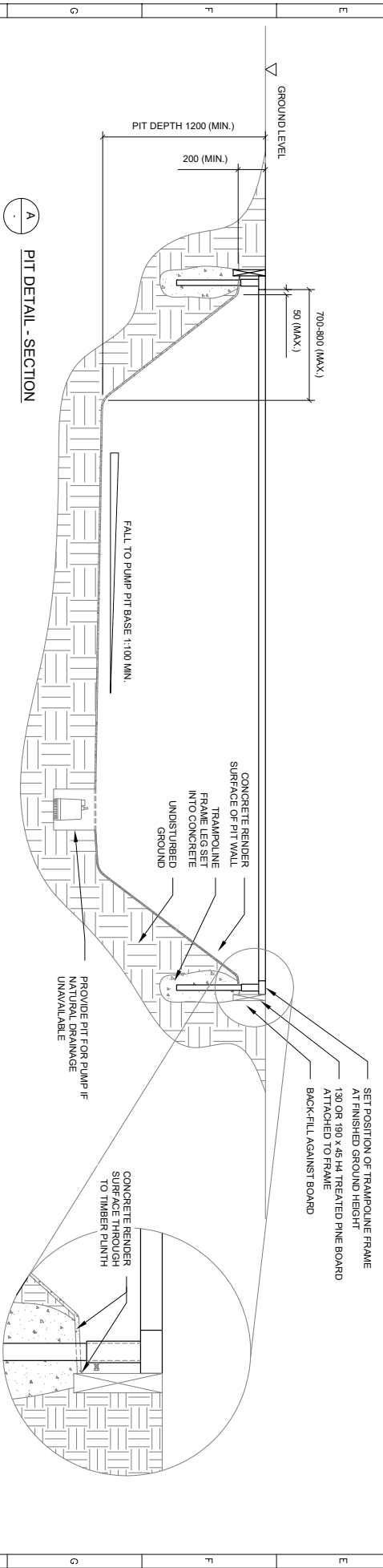
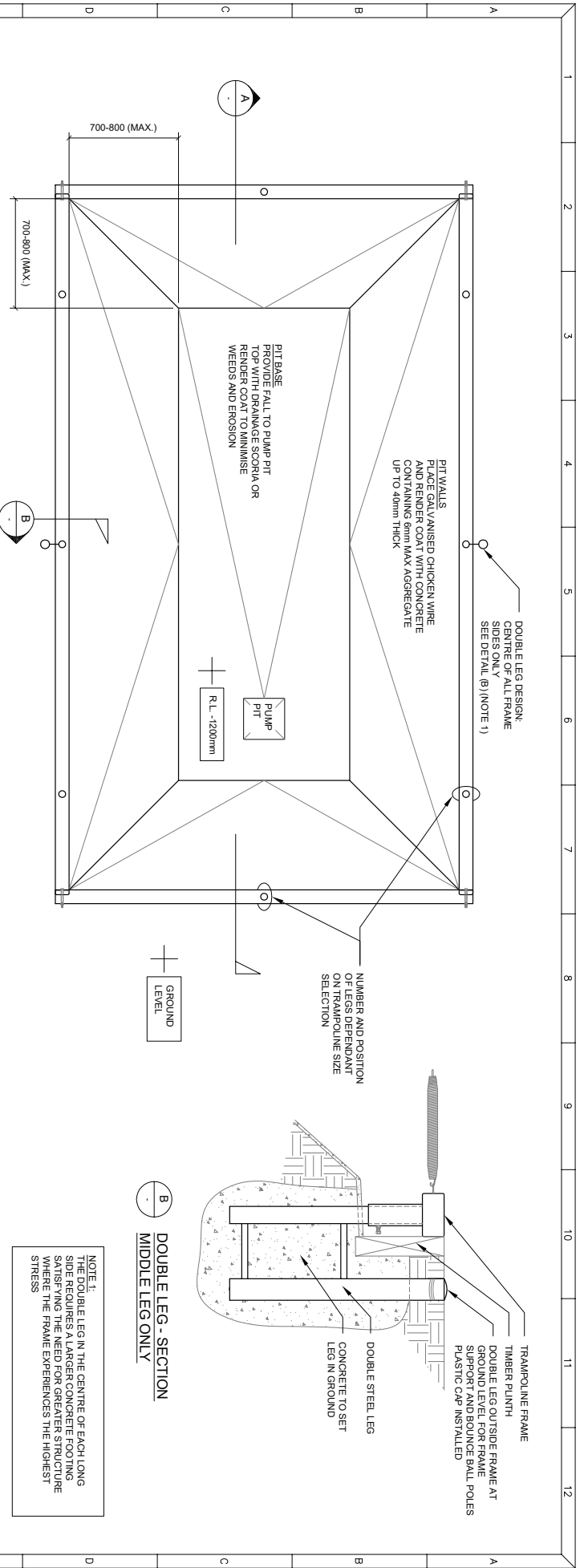

PIT DETAIL - SECTION

REV	DATE	DRAWN	DESCRIPTION	APPROV	DATE	DESIGN APPROVED	AR
1	14/01/16	WC	DOUBLE LEG DETAILS	-	-	DESIGNED	AR
0	10/09/16	WC	TABLE DETAILS	-	-	CAD DRAWN	WC
C	23/03/17	WC	ARRANGEMENT	-	-	DRAWING CHECK	WC
B	20/03/17	WC	WEDGE BAR DETAIL	-	-	CHECK	WC
A	17/03/17	WC	ISSUE FOR REVIEW	-	-	DESIGN APPROVED	AR

<p>+ MR TRAMPOLINE Premium Bounce. Ultimate Flight.</p>		<p>LOCATION N/A</p>
<p>TITLE IN GROUND TRAMPOLINE INSTALLATION</p>		<p>SCALE 1:30</p>
<p>PLAN AND SECTION</p>		<p>DRAWING NUMBER IG-05</p>
<p>1</p>		<p>PAPER A3</p>
<p>1</p>		<p>REV</p>

NOTE:
ISSUE FOR CONSTRUCTION

DOUBLE LEG - SECTION
MIDDLE LEG ONLY

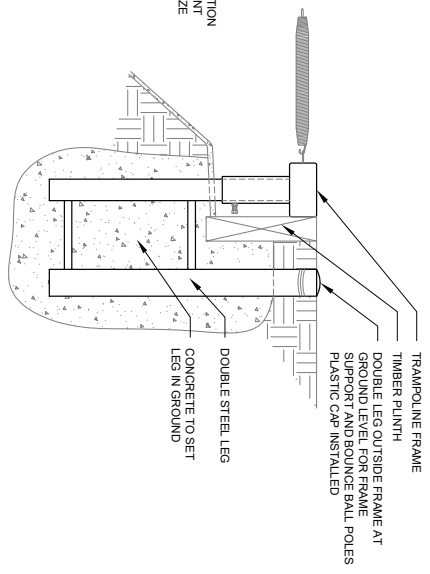

NOTE 1:
THE DOUBLE LEG IN THE CENTRE OF EACH LONG SIDE REQUIRES A LARGER CONCRETE FOOTING SATISFYING THE NEED FOR GREATER STRUCTURE WHERE THE FRAME EXPERIENCES THE HIGHEST STRESS

SET POSITION OF TRAMPOLINE FRAME
AT FINISHED GROUND HEIGHT
130 OR 190 X 45 HA TREATED PINE BOARD
ATTACHED TO FRAME
BACK-FILL AGAINST BOARD